



### 5/809-821 Botany Road Rosebery NSW

Harcourt Business Park is recognised as one of South Sydney's premier industrial estates. The property features functional office/warehouse units with air-conditioned and carpeted office accommodation on both ground floor and mezzanine levels. The estate also enjoys generous parking allocations for each unit.

Most units feature street frontage to either Botany Road, Harcourt Parade or Dunning Avenue. The units provide excellent truck access with container height roller shutters and 8 metre clearance, with a number of the larger units featuring two roller doors.

The property is located in close proximity to the Eastern Distributor, providing convenient access to the Sydney CBD as well as the North Shore. The estate is within walking distance of Mascot railway Station and is also

**Price** : POA  
**Building Size** : 801 sqm  
**View** : <https://www.cityalliance.com.au/lease/nsw/eastern-suburbs/rosebery/commercial/industrial/7227700>

**Disclaimer:** This plan has been prepared for marketing purposes only. Any interested party should undertake their own enquiries as to the accuracy of the information. Areas are approximate and dimension rounding may result in area discrepancies. Areas from Degotardi, Smith & Partners surveys dated 30/6/1999, 6/10/1999 & 21/10/1999.

**Information Schedule**

Unit	Ground Floor		First Floor	Total Area
	Warehouse	Office	Office	
1	764.0 sq m	312.9 sq m	356.8 sq m	1433.7 sq m
2	900.8 sq m	81.0 sq m	341.3 sq m	1323.1 sq m
3	566.5 sq m	270.4 sq m	281.7 sq m	1118.6 sq m
4	468.5 sq m	214.9 sq m	231.4 sq m	914.8 sq m
5	480.0 sq m	106.7 sq m	215.9 sq m	802.6 sq m
6	647.5 sq m	309.8 sq m	318.5 sq m	1275.8 sq m



FIRST FLOOR

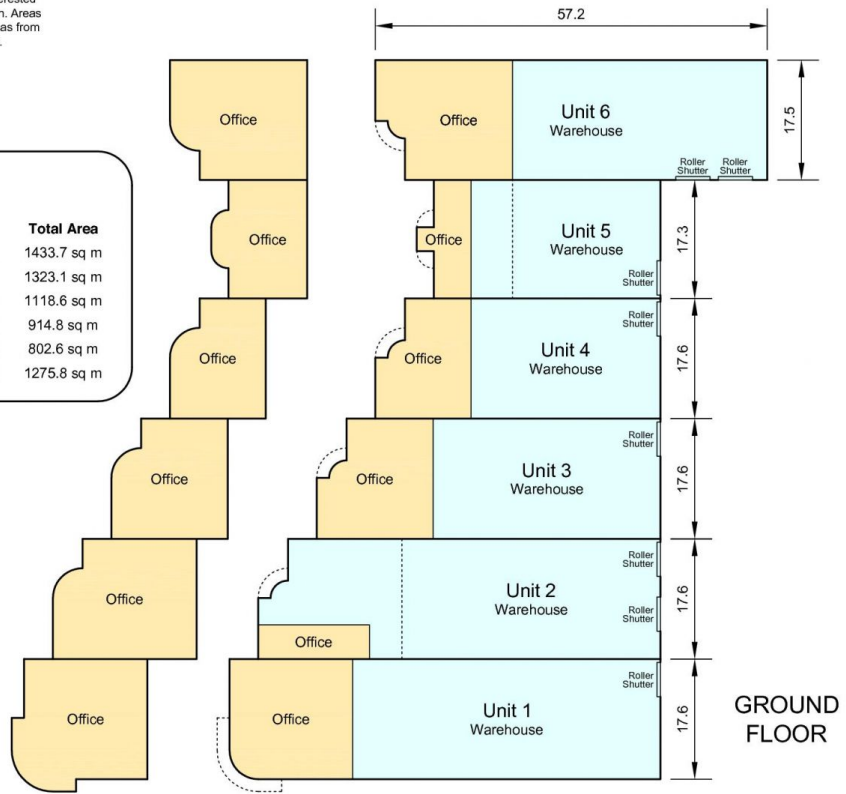

GROUND FLOOR

Plan prepared for:



**Units 1 - 6, HARCOURT ESTATE**  
809 - 821 Botany Road  
ROSEBERY, NSW

Date: 25/09/2002

Ref: 20852 Issue: A

Scale: 1:500 at A3

sydney canberra melbourne brisbane adelaide perth

**REALSERVE**  
Real Estate Plans & Surveys

P 02 9629 9377  
F 02 9475 5050  
www.realservice.com.au