

### Level 2/2.02/61 Dunning Avenue Rosebery NSW

Green Central offers contemporary office space conveniently located near some of Sydney's finest cafés and just 300m from a variety of retail options including Coles supermarket and a Medical Centre.

- ~ Windows on three sides of the building provide an abundance of natural light.
- ~ Contemporary design with landscaped gardens.
- ~ High Parking ratio of 1:45
- ~ 5 star NABERS energy rating.
- ~ Multipurpose basketball/tennis courts on-site for tenants to use and 500m from Turuwell Park.

**Price** : \$365/sqm Net (exGST)  
**Building Size** : 743 sqm  
**View** : <https://www.cityalliance.com.au/lease/nsw/eastern-suburbs/rosebery/commercial/offices/6705089>

## level 2 floor plan+

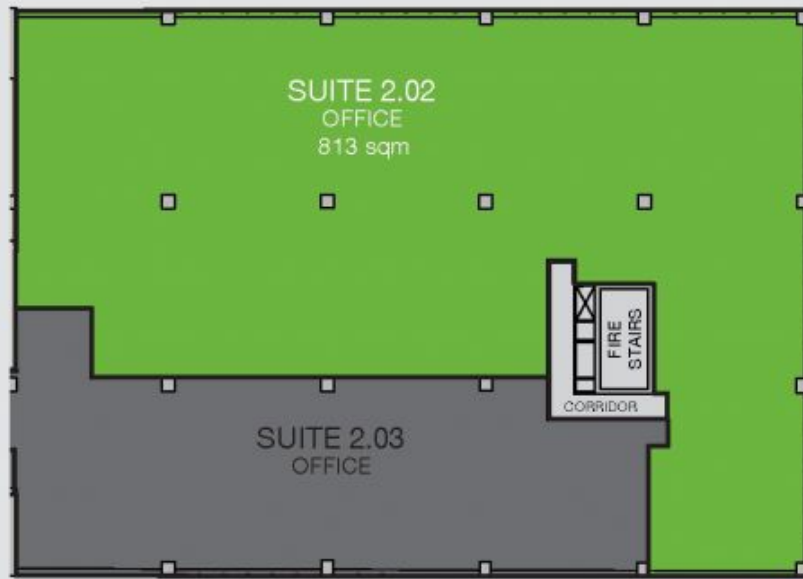

Area schedule	[sqm]
Suite 2.02	813